



EasyGlide is used for transfers in the seated position between wheelchair and bed, toilet or car seat. EasyGlide is available in a range of sizes to meet most transfer needs. The smaller model is often used by active patients who can manage transfers on their own.

There are different models of transfer assistive devices. The choice of assistive devices depends on the transfer situation and the patient's functional capability and needs.



Functional inspection

Visual inspection

Check the condition and function of the assistive device regularly. Check to ensure that fabric is not worn or faded. If there are signs of wear, the product must be discarded.

Functional inspection

Carefully bend the EasyGlide to check strength and durability. The mat should be both elastic and rigid. Discard the EasyGlide when its strength and durability are diminished.

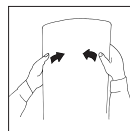

Always read the manual

Always read the manuals for all assistive devices used during a transfer.
Keep the manual where it is accessible to users of the product.
Do not leave the patient unattended during a transfer situation.

Max. weight

EasyGlide 5020, 60x33 cm

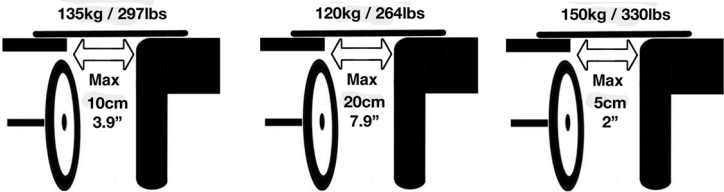

EasyGlide 5050, 75x33 cm

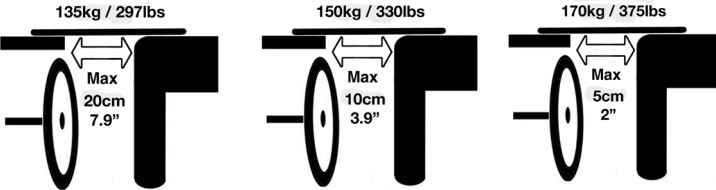

EasyGlide 5060, 60x25 cm

EasyGlide 5070, 45x20 cm

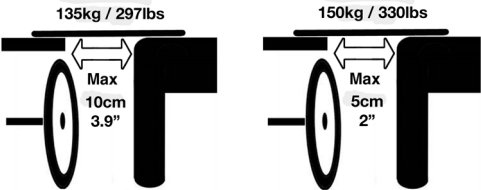

Placement/removal of EasyGlide

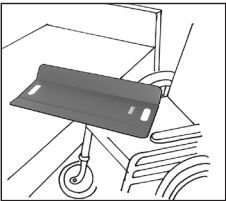

Place the wheelchair at an angle towards the side of the bed, and as close to the bed as possible. Remove the armrest that is closest to the bed and remove leg supports. Place the EasyGlide like a bridge between the bed and the wheelchair. If it is an EasyGlide model on which one long side can be bent, this should be placed against the wheelchair wheel. To position the EasyGlide under the patient, lean the patient slightly in the opposite direction.



When the transfer is complete, EasyGlide is removed by bending upwards (see image).

Using EasyGlide

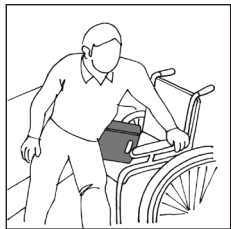

Active patients can transfer themselves with the help of EasyGlide. Grasp the armrest and lean over towards the wheelchair. It is important to remember to lean once more towards the bed when the transfer is complete, so as to be able to move back in the middle of the chair and slide all the way back.



If the patient requires support and assistance during the transfer, the EasyGlide should be complemented with an EasyBelt/FlexiBelt.



The caregiver can work from behind or in front of the patient.

Tips! Our FootStool can be used to advantage to raise the knees.

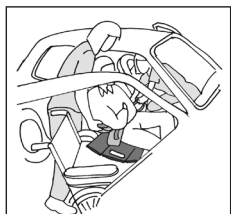

EasyGlide can also be used for transfers into and out of a car.

Material:

Polyethen

Care of the product:

Clean EasyGlide with water and disinfectant.

Size:

5020	60 x 33
5050	75 x 33
5060	60 x 25
5070	45 x 20

Contact your local distributor if you have any questions about the product and its use. See www.vancare.com for a complete list of distributors. Always make sure that you have the right version of the manual. The most recent editions of manuals are available for downloading from our website, www.vancare.com.

Manufactured for:

Vancare, Inc.
1515 First St
Aurora, NE 68818
1-800-694-4525
www.vancare.com
info@vancare.com